



Grand Theater Venue Rental 2019



Grand Theater	Half Theater	Lobby
		
<p>The Grand Theater rental includes the proscenium stage, exhibit, and lobby areas.</p> <p>Making up the entire ground floor, it is an excellent option for exhibits and large performances.</p> <p>7,000 sq. ft. 800 ppl 500 seated \$5,000 / day*</p>	<p>Our most popular rental includes the main proscenium stage, lobby, and bar.</p> <p>Perfect for performances and small conferences.</p> <p>3,000 sq. ft. 400 ppl 250 seated \$3,000 / day*</p>	<p>The lobby is an active retail space with large windows facing busy Mission Street.</p> <p>It is ideal for small functions, pop up retail and showcases.</p> <p>1,000 sq. ft. 100 ppl 50 seated \$1,000 / day*</p>

* Venue rental rates include 8 hours of rental time, any hours over 8 hours are charged at a rental rate of \$150/hour.

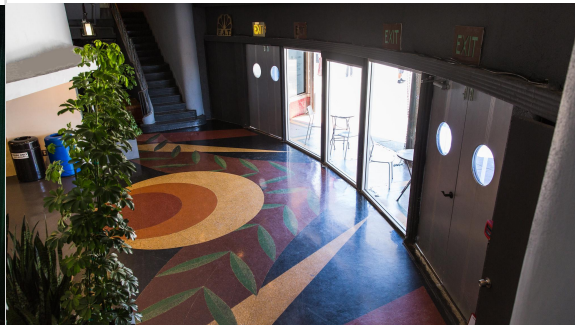
Important Information

Booking:

- To secure your venue rental, Gray Area requires a signed contract and a non-refundable deposit of 20% of the event cost.
- Venue rentals require a mandatory \$1,000,000.00 certificate of insurance general liability.

Staffing:

- Gray Area will provide one event supervisor to be on site for all event rental hours.
- Venue Rentals are required to hire Gray Area's security guard that is licensed and bonded for the entirety of the public hours of event. The rate per guard is \$35/hour. We require at least one security guard for each 100 guests.
- Venue Rentals are required to hire Gray Area's housekeeping staff for the entirety of the public hours of the event at a rate of \$25/hour. We require one housekeeping staff per 400 guests. Hiring our housekeeping staff ensures cleanliness and maintenance for the event.
- Venue Rentals are required to hire one door staff per 200 guests for guest registration. At least one door staff must be present at **all** times. Upon request, Gray Area can provide door staff at a rate of \$25/hour.
- Upon request, production staff is available to assist with preparation, installation, or de-installation at a rate of \$35/hour.

Event Trash:

- Gray Area will dispose of six 30 gallon bags of trash free of charge.
- All other trash generated by event rentals will be billed at a rate of \$10 per 30 gallon trash bag.

Community Rentals:

- Gray Area is proud to offer a community rentals program to organizations with non-profit 501(c)3 status to leverage our space for community support and social good. Events or organizations that qualify for this program must satisfy the following program goals:
 - To serve the local Mission District community
 - To elevate and organize around issues of social justice
 - To support, or increase visibility of, underserved communities
 - To advance under-supported fields in the arts and/or in technology

Equipment

Gray Area provides rentals of audio/visual equipment and select furniture for a nominal fee.

Here is our inventory list and on the next page check out our A/V packages for theater presentations.



Item	Rate / Day	Quantity
Sofas	Free	3
Arm Chairs	Free	4
Podium	Free	1
Table 2'x4'	\$10	4
Table 6'x30"	\$10	5
Table 7'x30"	\$10	4
Table Linen(black)	\$5	20
Cocktail table 24" round (41" high)	\$10	10
Black Folding Chairs	\$2	340
Bar Stools	\$2	18
Plinths (assorted sizes)	\$5	6
Confidence Monitor	\$100	1
Small Projectors	\$50	5

Audio Visual Packages

Depending on the size and structure of your event. Gray Area has two sound system packages and one digital projection package available. We can also provide technicians to help ensure your event runs smoothly for \$50/hour.

Item	Rate Per Day	Specs
Digital Projection Package	\$250	Christie Projector DWU775-E HD Video Mixer 14'x27' projection screen
Small Sound System Package	\$150	FBT Amico 900 powered speakers & stands (flexible speaker placement) Mackie 1202VLZ4 12 channel Mixer, 1 wired microphone, 1 microphone stand
Theater Sound System Package	\$1,000*	16 channel 120Db L'Acoustics sound system, Suitable for DJs and live music for events of 100-800 * Rental of the theater sound system for purposes outside of microphone dialogue or .mp3 playback requires a sound engineer at a rate of \$50/hour.

Bar Options

Hosted Bar:

- Host pays the bar tab for the entire bar for all guests.
- An 18% service charge will be added to the final bill.

Cash Bar:

- Guests pay for drinks.
- Drink tickets can be purchased by host for selected guests.

Gray Area offers a Hosted Bar or a Cash Bar option with service available for either beer and wine or a full bar with mixed drinks. We require a \$1,000 minimum in bar sales for beer and wine service and \$1,500 for a full bar with mixed drinks. Ask for our bar menu for more details.

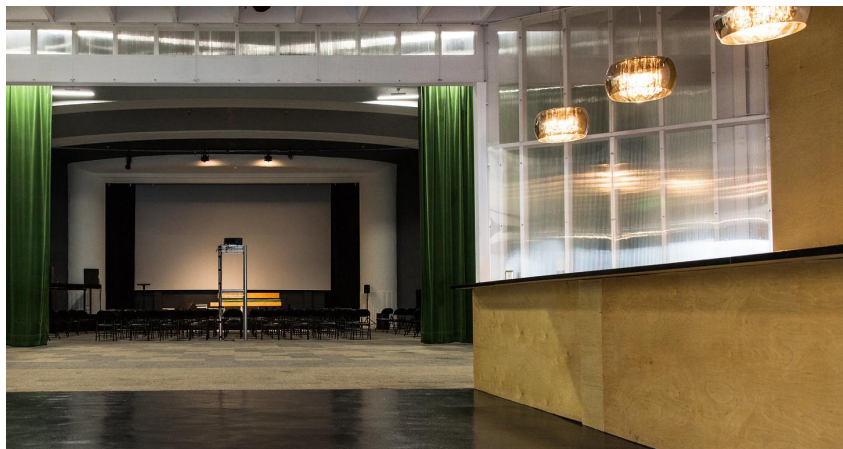

Theater Areas

Depending on the theater rental type you select, only certain areas are included in your rental. The Exhibit and Proscenium areas are separated by a large velvet theater curtain. The Mezzanine area can be available to rent upon request.

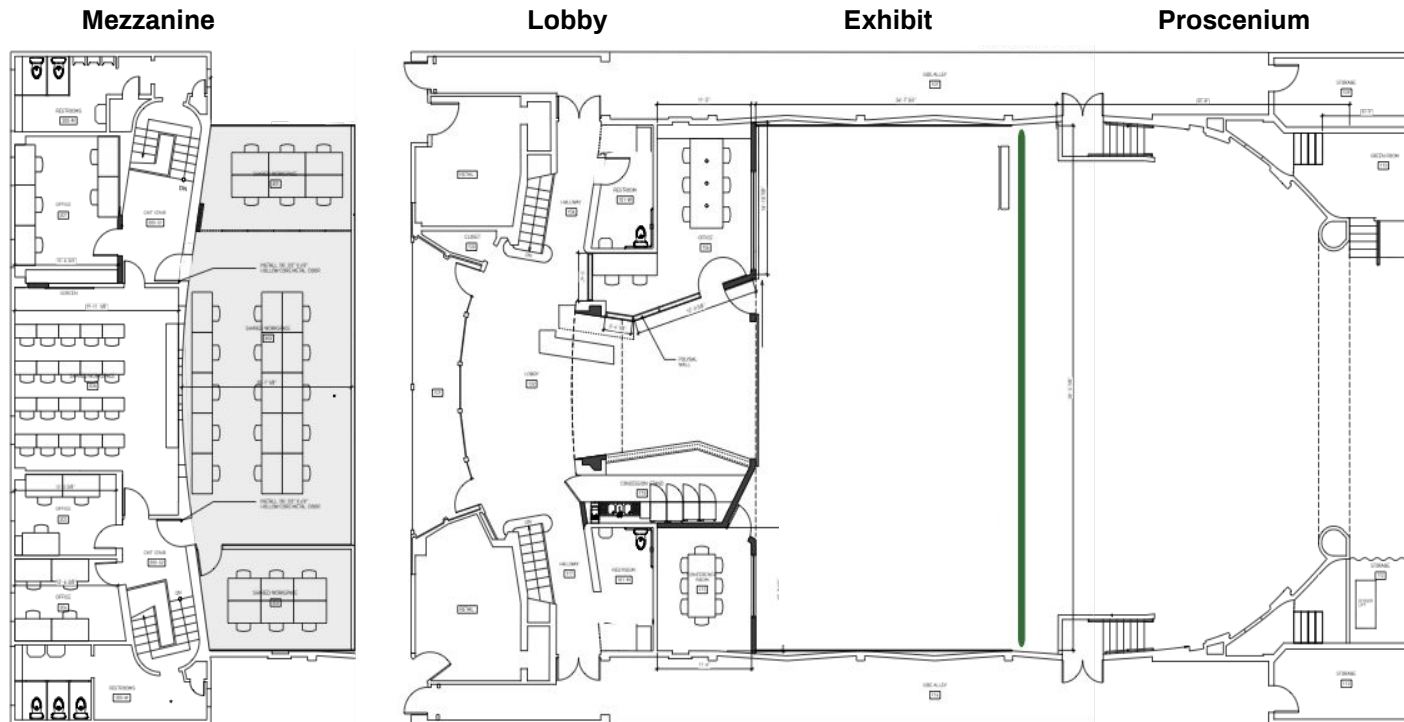

Grand Theater

This Layout includes the entire ground floor of Gray Area; The Lobby, Exhibit space, and Proscenium areas.

The Conference Room and Storage Room are included as well. Our Beverage Concessions are always managed by Gray Area.

The Grand Theater capacity is 800 standing and 500 seated.

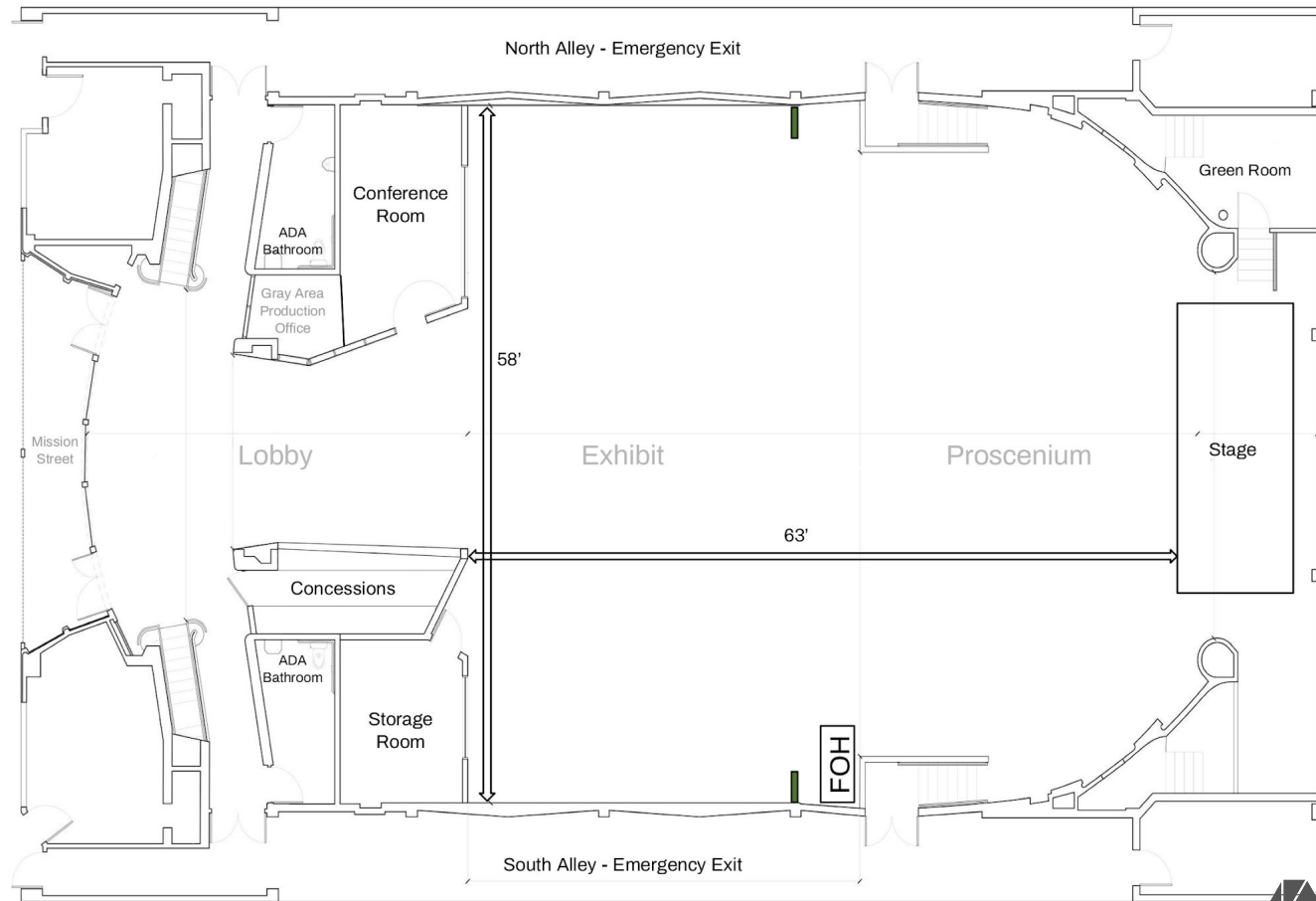

Half Theater

This layout includes the Lobby, and Proscenium areas connected by a hallway created with moveable walls.

The conference room, storage room and areas behind rolling walls are not provided in the Half Theater Layout but can be added on for an additional fee. Our Beverage Concessions are always managed by Gray Area.

This layout has a seated capacity of 250, and a standing capacity of 400.

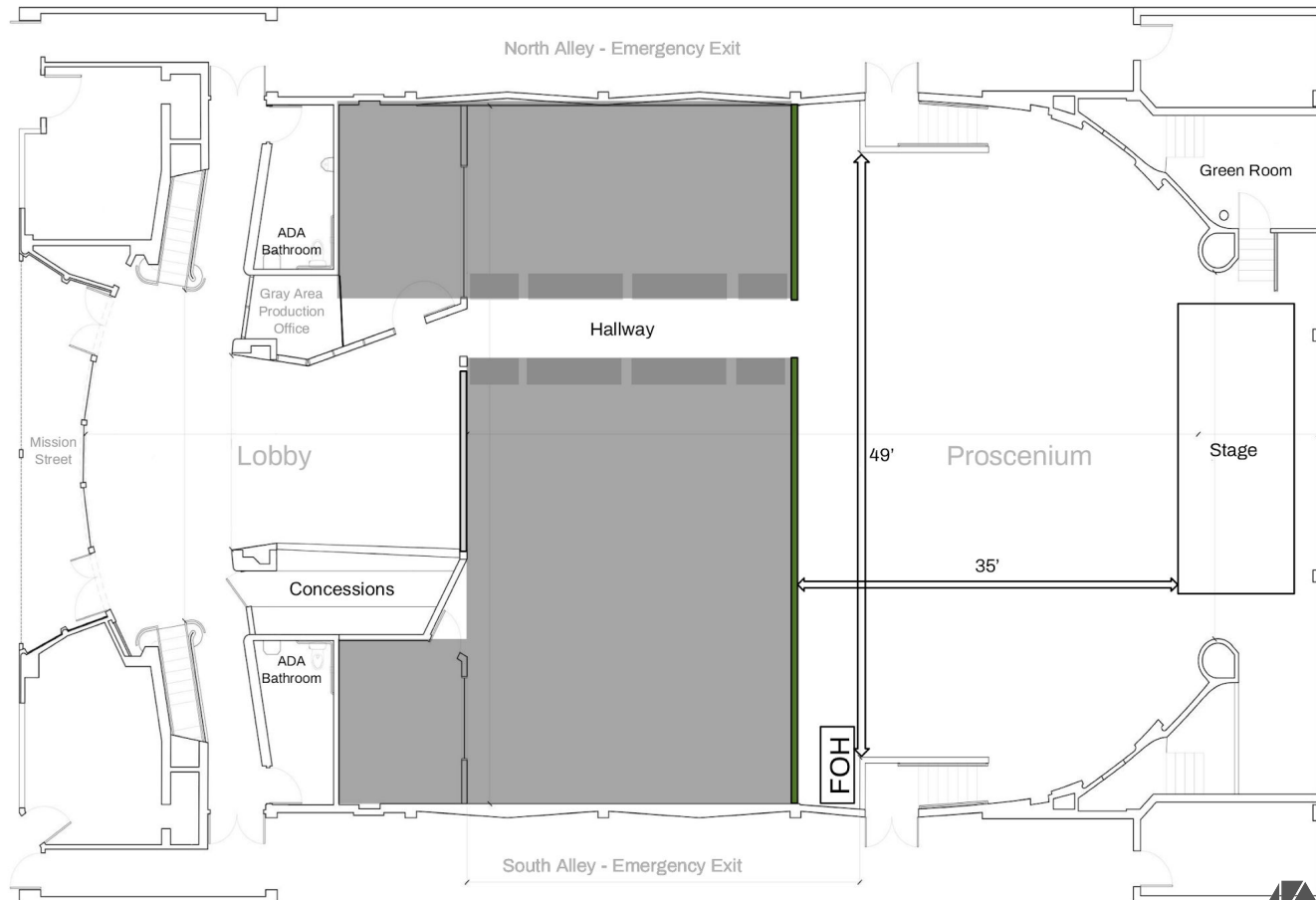



Full Theater Immersive Performance



A full theater dance performance is taking place in a large, dimly lit hall. The stage is dark, and the background is a large projection of a night sky with a full moon and clouds. The audience is seated in the foreground, and the dancers are performing on the stage. The lighting is focused on the stage, creating a dramatic effect. The dancers are wearing minimal clothing, and their movements are fluid and expressive. The overall atmosphere is one of artistic expression and cultural celebration.

Full Theater Dance Performance



Exhibition

Urban Heartbeat:

Visualizing real-time data about neighborhoods



Lobby Workshop



Zilliqa

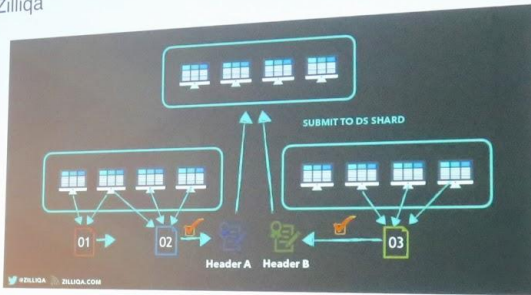

Half Theater Conference



Work with Gray Area to support art and technology | grayarea.org/book

